

JOINT KIT	ØA	X	Y	NUT A/F	BOLT Ømm	PITCH	PCD
1/4"	100	79	60	13	M8	1.25	80
3/8"	100	100	75	19	M12	1.75	80
1/2"	100	120	88	24	M16	2.00	80
3/4"	140	182	142	36	M24	3.00	120
1"	113	187	137	46	M30	3.50	80

UTA TABLE TOP JOINT KITS FOR ROTARY TRANSDUCERS

INTRODUCTION

This joint kit is designed as a convenient, repeatable, variable stiffness joint for assessing the performance of torque tools in a practical way. It is designed to be bolted to a table top and used in conjunction with Crane CheckStar transducers for testing power tools.

Each kit may be assembled in different ways to vary the stiffness of the joint. Reference should be made to TABLE 1 to select from the available options. Care should be taken to ensure that as well as choosing the most suitable stiffness, the maximum torque for the joint is not exceeded. Please note that the joint kit is not designed to provide an exact joint stiffness.

Torque tools are influenced by joint hardness. For the most accurate assessment of how your torque tool will perform in production use, Crane recommends the use of an in line transducer (such as CheckStar) to take joint variability into account.

See back page for dimensions.

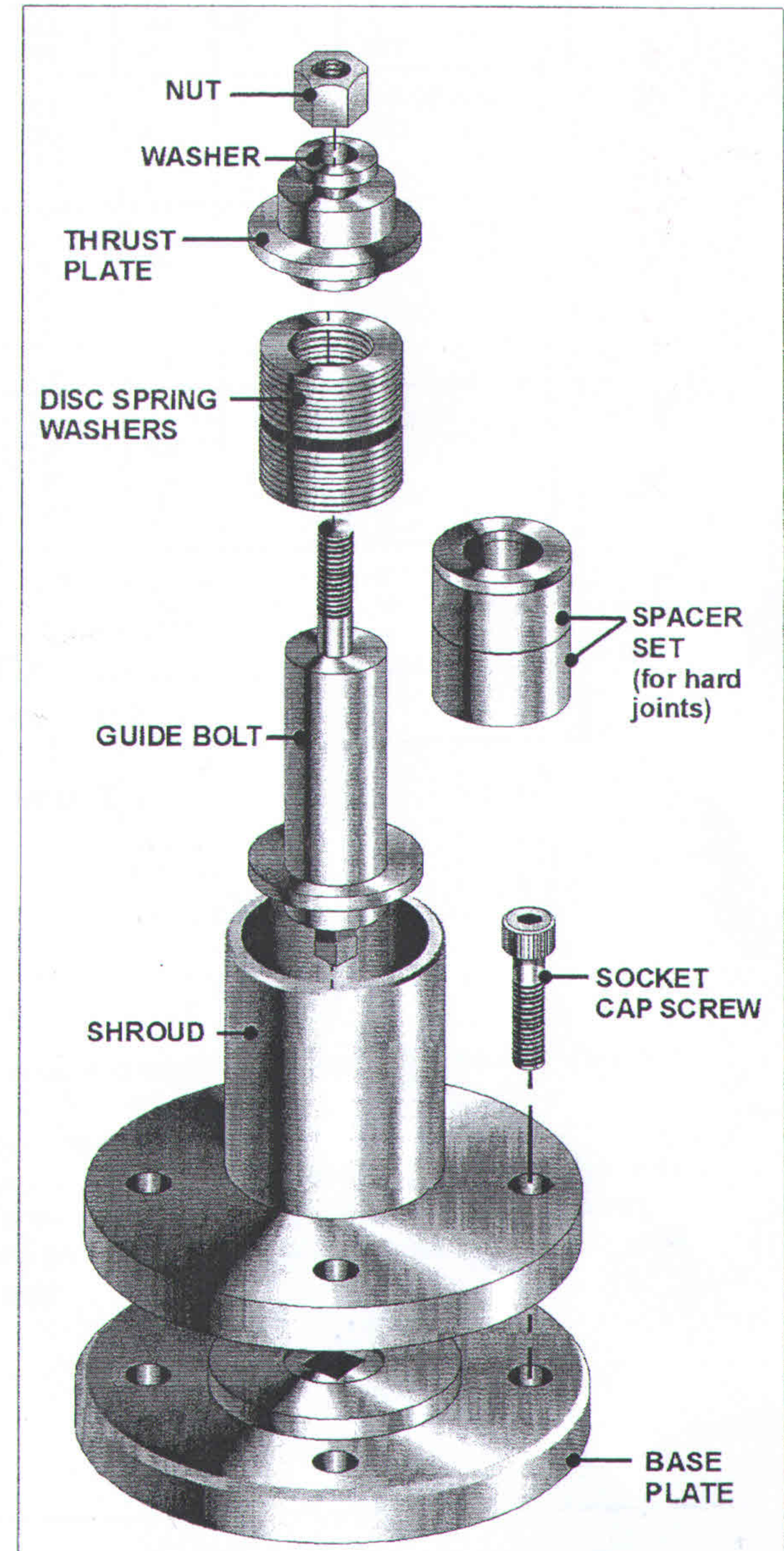

PACKING LIST

Each Joint Kit contains the following Items

1X THRUST PLATE	1X NUT
1X SPACER SET	1X BASEPLATE
?X DISC SPRING WASHERS (See table below)	4X SOCKET CAP SCREWS
1X HARD WASHER	1X SHROUD (except for 1" where baseplate and shroud are combined)
1X GUIDE BOLT	

Please check these items are all present. Notify Crane Electronics Ltd (CEL) immediately of

JOINT KIT PART NUMBERS			
Part No.	Size	Description	No. of Disc Spring Washers
JK-875-06CR-28-0	1/4"	TABLE TOP JOINT KIT	24
JK-875-07CR-135-0	3/8"	TABLE TOP JOINT KIT	18
JK-875-08CR-271-0	1/2"	TABLE TOP JOINT KIT	18
JK-875-09CR-1017-0	3/4"	TABLE TOP JOINT KIT	20
JK-875-10CR-1695-0	1"	TABLE TOP JOINT KIT	10

BOLT KIT PART NUMBERS (For female joint kits and table top joint kits)		
Part No.	Size	Description
JK-875-13CR-0-0	1/4"	FEMALE BOLT KIT
JK-875-14CR-0-0	3/8"	FEMALE BOLT KIT
JK-875-15CR-0-0	1/2"	FEMALE BOLT KIT
JK-875-16CR-0-0	3/4"	FEMALE BOLT KIT
JK-875-17CR-0-0	1"	FEMALE BOLT KIT

SPARES PARTS LIST						
SIZE	THRUST PLATE	SPACER SET	DISC SPRING WASHERS	HARD WASHER	SHROUD	BASEPLATE
1/4"	1401398	1401399	1401416 (x24)	1401505	1403837	1403832
3/8"	1401402	1401403	1401417 (x18)	1401506	1403838	1403833
1/2"	1401406	1401407	1401418 (x18)	1401507	1403839	1403834
3/4"	1401410	1401411	1400407 (x20)	1401508	1403840	1403835
1"	1401414	1401415	1401419 (x10)	1401509	N/A	1403836

IMPORTANT

Grease the threads before fitting the nut.

Ensure that the threads are kept lubricated.

NOTE: For greasing the threads, a Moly based, high temperature, high impact K48 type grease should be used, and a suitable solvent for cleaning - i.e. a trichloethylene based solvent or substitute. (CEL recommends an industrial rapid drying spray cleaner.) Threads should be cleaned and greased every 50-100 cycles.

Eventually the bolt and nut threads will wear and these will require replacement. Use only official CEL replacement parts.

TABLE 1

NOMINAL JOINT STIFFNESS AVAILABLE						
	JOINT KIT	MAX TORQUE		1st Stack	2nd Stack	SPACER(S) mm
		Nm	lbin			
SOFT ↓ HARD	1/4"	5.6 13.6 21.5 28.25 28.25	50 120 190 250 250	3 6 12 24 -	3 6 12 - -	17.1 11.5 - - 11.5+12.3
SOFT ↓ HARD	3/8"	67.8 120 100 100	50 90 73.75 73.75	5 9 16 -	5 9 - -	15.5 - 5 5+18.6+15.5
SOFT ↓ HARD	1/2"	135.6 220 271 271	100 160 200 200	5 9 9 -	5 9 - -	19.5 - 23.3 3.9+23.3+19.5
SOFT ↓ HARD	3/4"	460 830 775 1017	340 610 570 750	5 10 10 -	5 10 - -	39.5 - 41.3 39.2+41.3
SOFT ↓ HARD	1"	847 1600 1400 1695	625 1180 1030 1250	3 5 9 -	3 5 - -	24 - 8 8+24+32